

Test Probe

GKS-100 306 250 A 1000 LH

Item GKS-100-1701



GO TO PRODUCT

ingun[®]

Partner for Future Technology

- Well-established test probes for contacting PCBs



1:1

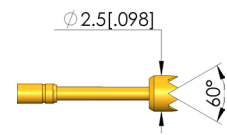
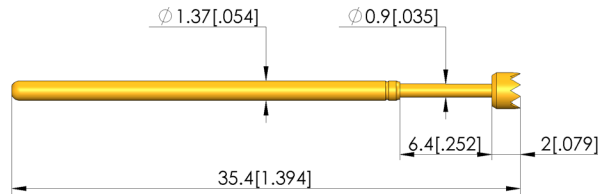
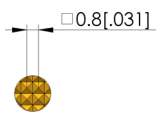

General data

Product group:
Sub-product group:
Series:
Grid:
Contacting from:
Magnetic:
Installation type:
Quick-exchange system:
Adjustable installation height:
Non-rotating:
Compatible receptacle(s):
Min. temperature:
Max. temperature:
RoHS-compliant:

ICT / FCT (in-circuit test and function test)
Standard stroke test probe
GKS-100 LH long version
3 mm [118 mil]
Post
Yes
Plug-in
Yes
No
No
KS-100
-40 °C [-40 °F]
80 °C [176 °F]
Yes

Tip style data

Tip style:
Tip diameter:
Tip style surface:
Tip style material:

06 serrated
2.5 mm [.098 in]
A gold
3 CuBe

Electrical data

Current load capacity / rated current:
Typical resistance (Ri):

5 A
20 mOhm

Mechanical data

Total length:
Barrel diameter:
Maximum stroke:
Spring pre-load:
Collar height:
Spring force at working stroke:
Recommended working stroke:

35.4 mm [1.39 in]
1.37 mm [.053 in]
6.35 mm [.25 in]
0.28 N [1 ozf]
00
1 N [3.59 ozf]
4.3 mm [.169 in]

Test Probe

GKS-100 306 250 A 1000 LH

Item GKS-100-1701



GO TO PRODUCT

ingun[®]

Partner for Future Technology

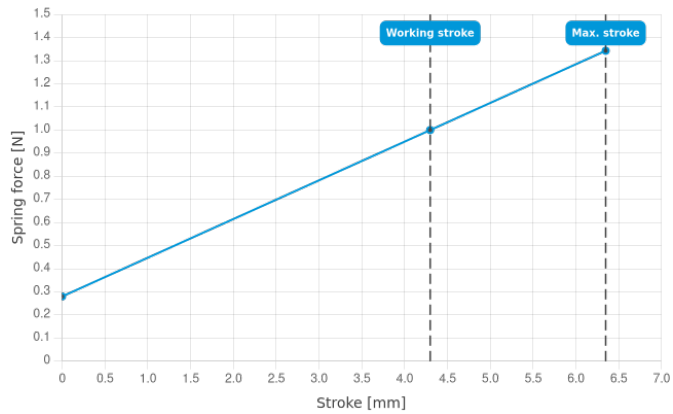

INGUN Prüfmittelbau GmbH

Max-Stromeyer-Straße 162
78467, Constance, Germany
Phone +49 7531 8105-0
Customer hotline +49 7531 8105-888
Fax +49 7531 8105-65
info@ingun.com



Prices and delivery times on request.
Technical changes reserved. 01/26_GB

Learn more about
ICT/FCT Test probes



ICT/FCT TEST PROBES

ingun.com