

High-current test probe

HSS-120 305 300 A 3005

Item HSS-120-0406



GO TO PRODUCT

ingun[®]

Partner for Future Technology

- Trusted, robust high-current probes, optimally sized for current load capacity ratio
- Low-Ohm probe with Ri typical: < 10 mOhm
- For use in function and burn-in tests
- Large selection of tip styles and spring forces for optimum contact with DUT
- Optimum adjustment of the stroke ratios in the test fixture: The test probe collar is available in different heights, which, in combination with the receptacles, allows a range of installation heights

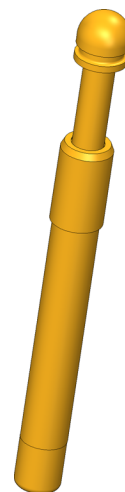

1:1

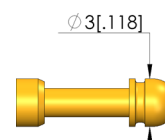
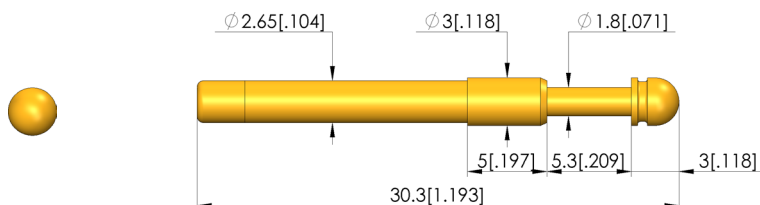

General data

Product group:
Sub-product group:
Series:
Grid:
Contacting from:
Magnetic:
Installation type:
Quick-exchange system:
Adjustable installation height:
Compatible receptacle(s):
Min. temperature:
Max. temperature:
RoHS-compliant:

Standard HSS (press-in)
Standard HSS (press-in)
HSS-120
4 mm [157 mil]
Pad
Yes
Plug-in
Yes
No
KS-113
-100 °C [-148 °F]
200 °C [392 °F]
Yes

Tip style data

Tip style:
Tip diameter:
Tip style surface:
Tip style material:

05 bullet-nosed (full radius)
3 mm [.118 in]
A gold
3 CuBe

Electrical data

Current load capacity / rated current:
Typical resistance (Ri):

30 A
10 mOhm

Mechanical data

Total length:
Barrel diameter:
Maximum stroke:
Spring pre-load:
Collar height:
Spring force at working stroke:
Recommended working stroke:

30.3 mm [1.19 in]
2.65 mm [.104 in]
5.3 mm [.208 in]
0.71 N [2.55 ozf]
5
3 N [10.7 ozf]
4 mm [.157 in]

High-current test probe HSS-120 305 300 A 3005

Item HSS-120-0406



ingun[®]

Partner for Future Technology

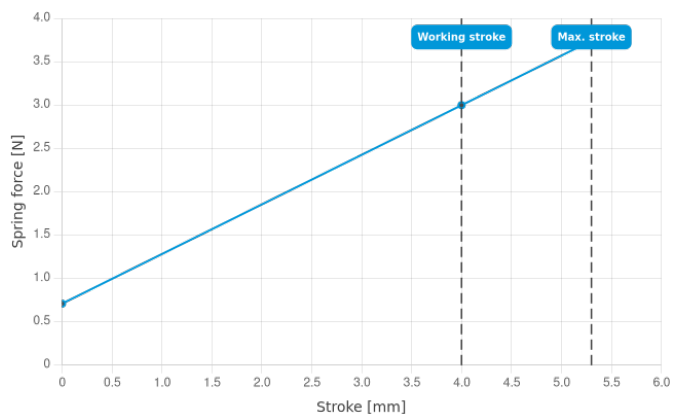

INGUN Prüfmittelbau GmbH

Max-Stromeyer-Straße 162
78467, Constance, Germany
Phone +49 7531 8105-0
Customer hotline +49 7531 8105-888
Fax +49 7531 8105-65
info@ingun.com



Prices and delivery times on request.
Technical changes reserved. 11/25_GB

Learn more about
High-current test probes



ingun.com

HIGH-CURRENT TEST PROBES