

High-current test probe

HSS-005 313 203 A 3000

Item HSS-005-0003



GO TO PRODUCT

ingun[®]

Partner for Future Technology

- Trusted, robust high-current probes, optimally sized for current load capacity ratio
- Low-Ohm probe with Ri typical: < 10 mOhm
- For use in function and burn-in tests
- Large selection of tip styles and spring forces for optimum contact with DUT
- Optimum adjustment of the stroke ratios in the test fixture: The test probe collar is available in different heights, which, in combination with the receptacles, allows a range of installation heights

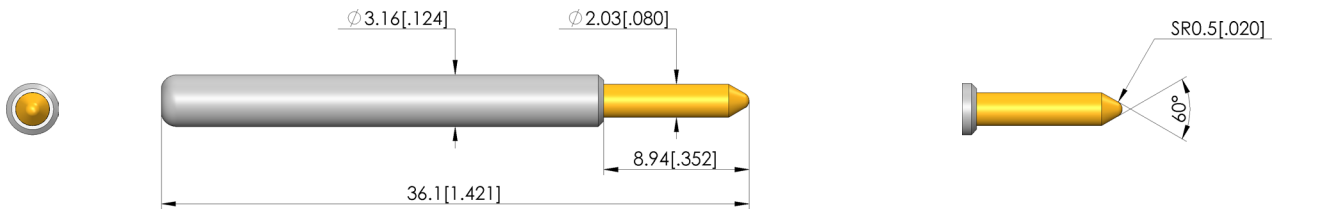
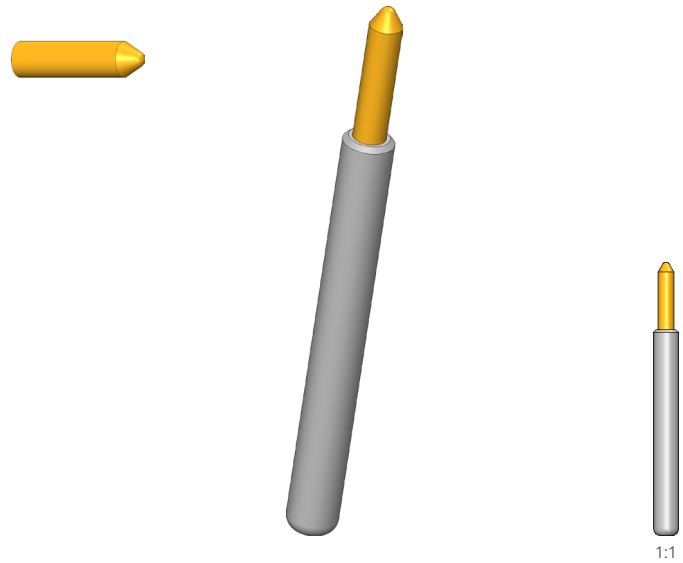

General data

| | |
|---------------------------------|----------------------------|
| Product group: | International standard HSS |
| Sub-product group: | International standard HSS |
| Series: | HSS-005 |
| Grid: | 4.75 mm [187 mil] |
| Contacting from: | Pad |
| Magnetic: | Yes |
| Installation type: | Plug-in |
| Quick-exchange system: | Yes |
| Adjustable installation height: | No |
| Non-rotating: | No |
| Compatible receptacle(s): | KS-005 |
| Min. temperature: | -100 °C [-148 °F] |
| Max. temperature: | 200 °C [392 °F] |
| RoHS-compliant: | Yes |

Tip style data

| | |
|---------------------|----------------------------|
| Tip style: | 13 30° needle tip, rounded |
| Tip diameter: | 2.03 mm [.079 in] |
| Tip style surface: | A gold |
| Tip style material: | 3 CuBe |

Electrical data

| | |
|--|--------|
| Current load capacity / rated current: | 40 A |
| Typical resistance (Ri): | 5 mOhm |

Mechanical data

| | |
|---------------------------------|-------------------|
| Total length: | 36.1 mm [1.42 in] |
| Barrel diameter: | 3.16 mm [.124 in] |
| Maximum stroke: | 6.35 mm [.25 in] |
| Spring pre-load: | 1.26 N [4.53 ozf] |
| Collar height: | 00 |
| Spring force at working stroke: | 3 N [10.7 ozf] |
| Recommended working stroke: | 4.4 mm [.173 in] |

HIGH-CURRENT TEST PROBES

High-current test probe HSS-005 313 203 A 3000

Item HSS-005-0003



ingun[®]

Partner for Future Technology

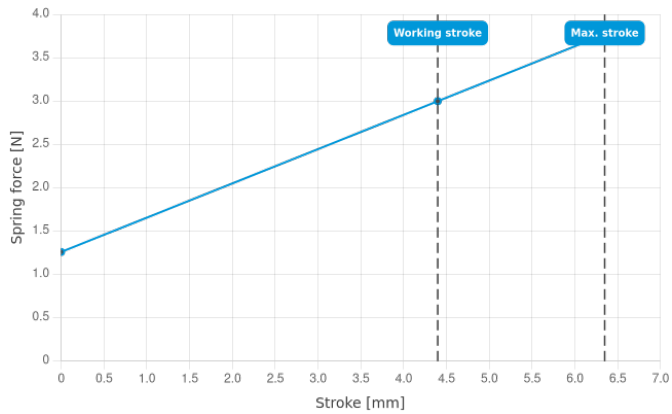

INGUN Prüfmittelbau GmbH

Max-Stromeyer-Straße 162
78467, Constance, Germany
Phone +49 7531 8105-0
Customer hotline +49 7531 8105-888
Fax +49 7531 8105-65
info@ingun.com



Prices and delivery times on request.
Technical changes reserved. 12/25_GB

Learn more about
High-current test probes



HIGH-CURRENT TEST PROBES

ingun.com