

# Push rod

## NHS-ST-15,0-5,0-POM-D3

Item 12681



GO TO PRODUCT

**ingun**<sup>®</sup>

Partner for Future Technology

- Trusted push rods for reliable, rigid fixing of the PCB in the probe field against the force of the test probes
- Robust, pressure-resistant design
- Quick, easy installation

### Application

Push rods (NHS) are used in customisations to securely hold electronic circuit boards in place against the force of the test probes during contacting in the test fixture. Push rods are mounted in the pressure frame plate.



1:1

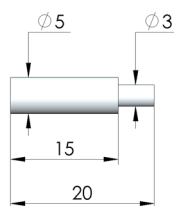

### General data

Product group:  
Series:  
Type:  
Version:  
Accessory type:  
Outer dimensions (TxL):

Push rods (NHS)  
NHS-ST  
Rigid  
Not ESD compliant  
Customising accessories  
5 x 20 mm [.196 x .787 in]

### Compatible with

Vacuum test fixtures (VA):

VA 207x-ZSK

### Technical data

Tip diameter:  
Pushrod shaft diameter:  
Tip material:  
True running:  
Installation:  
Thread:  
Tip length:

5 mm [.196 in]  
3 mm [.118 in]  
POM

Plugged  
Ø 3,0x5 mm  
15 mm [.59 in]

### Mechanical data

Total length: 20 mm [.787 in]

### INGUN Prüfmittelbau GmbH

Max-Stromeyer-Straße 162  
78467, Constance, Germany  
Phone +49 7531 8105-0  
Customer hotline +49 7531 8105-888  
Fax +49 7531 8105-65  
info@ingun.com



Prices and delivery times on request.  
Technical changes reserved. 11/25\_GB