

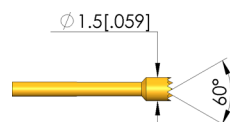

GO TO PRODUCT

- Long-stroke test probe for implementing combined ICT and FCT in a dual-stage fixture
- For optimum contact at the test points (e.g. pads, vias, and pins), various tip styles in different diameters and finishes, as well as various spring forces are available. spring forces.
- Used for setting the optimum stroke conditions in the test fixture, various installation heights can be achieved by combining test probes and receptacles

### INGUN SELECTION

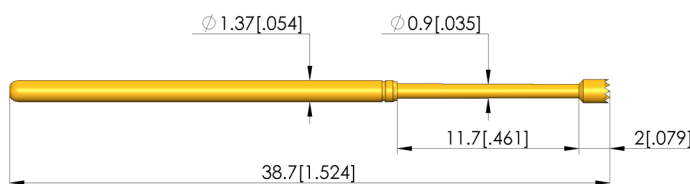
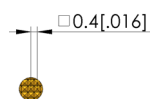

1:1

#### General data

Product group:  
Sub-product group:  
Series:  
Grid:  
Contacting from:  
Magnetic:  
Installation type:  
Quick-exchange system:  
Adjustable installation height:  
Non-rotating:  
Compatible receptacle(s):  
Min. temperature:  
Max. temperature:  
RoHS-compliant:

ICT / FCT (in-circuit test and function test)  
Long stroke GKS  
GKS-135  
2.54 mm [100 mil]  
Post  
Yes  
Plug-in  
Yes  
No  
No  
KS-100  
-40 °C [-40 °F]  
80 °C [176 °F]  
Yes

#### Tip style data

Tip style:  
Tip diameter:  
Tip style surface:  
Tip style material:

06 serrated  
1.5 mm [0.059 in]  
A gold  
3 CuBe

#### Electrical data

Current load capacity / rated current:  
Typical resistance (Ri):

5 A  
30 mOhm

#### Mechanical data

Total length:  
Barrel diameter:  
Maximum stroke:  
Spring pre-load:  
Collar height:  
Spring force at working stroke:  
Recommended working stroke:

38.7 mm [1.52 in]  
1.37 mm [0.053 in]  
11.5 mm [0.452 in]  
0.21 N [0.047 lbf]  
0  
2 N [0.45 lbf]  
9.3 mm [0.366 in]

# Test Probe

## GKS-135 306 150 A 2000

Item GKS-135-0019



**ingun**<sup>®</sup>

Partner for Future Technology

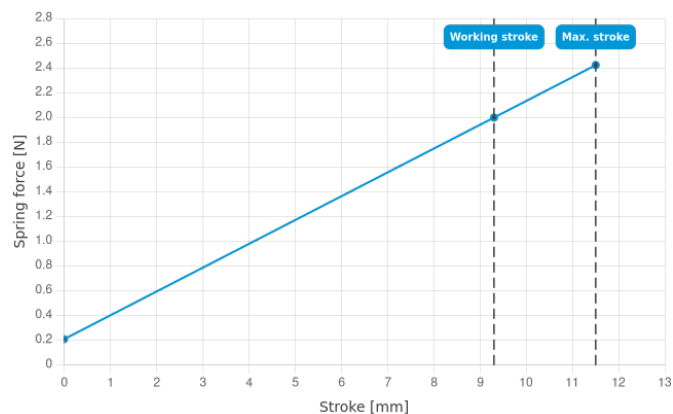

### INGUN Prüfmittelbau GmbH

Max-Stromeyer-Straße 162  
78467, Constance, Germany  
Phone +49 7531 8105-0  
Customer hotline +49 7531 8105-888  
Fax +49 7531 8105-65  
info@ingun.com



Prices and delivery times on request.  
Technical changes reserved. 11/25\_GB

Learn more about  
ICT/FCT Test probes



[ingun.com](https://www.ingun.com)