

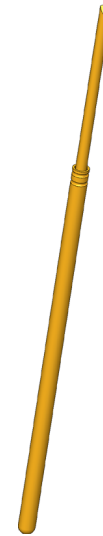

- Long-stroke test probe for implementing combined ICT and FCT in a dual-stage fixture
- For optimum contact at the test points (e.g. pads, vias, and pins), various tip styles in different diameters and finishes, as well as various spring forces are available. spring forces.
- Used for setting the optimum stroke conditions in the test fixture, various installation heights can be achieved by combining test probes and receptacles

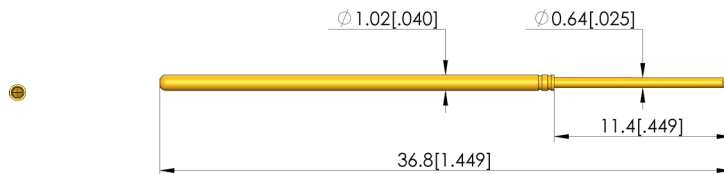

1:1

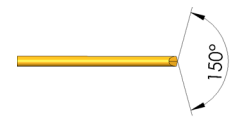

General data

Product group:	ICT / FCT (in-circuit test and function test)
Sub-product group:	Long stroke GKS
Series:	GKS-035
Grid:	1.91 mm [75.1 mil]
Contacting from:	
Magnetic:	Yes
Installation type:	Plug-in
Quick-exchange system:	Yes
Adjustable installation height:	No
Non-rotating:	No
Compatible receptacle(s):	KS-075
Min. temperature:	-40 °C [-40 °F]
Max. temperature:	80 °C [176 °F]
RoHS-compliant:	Yes

Tip style data

Tip style:	38 150° passive dagger, self-cleaning
Tip diameter:	0.64 mm [.025 in]
Tip style surface:	A gold
Tip style material:	2 steel

Electrical data

Current load capacity / rated current:	3 A
Typical resistance (Ri):	20 mOhm

Mechanical data

Total length:	36.8 mm [1.44 in]
Barrel diameter:	1.02 mm [.04 in]
Maximum stroke:	10 mm [.393 in]
Spring pre-load:	0.21 N [.755 ozf]
Collar height:	00
Spring force at working stroke:	1.2 N [4.31 ozf]
Recommended working stroke:	8 mm [.314 in]

Test Probe

GKS-035 238 064 A 1200

Item GKS-035-0056



ingun[®]

Partner for Future Technology

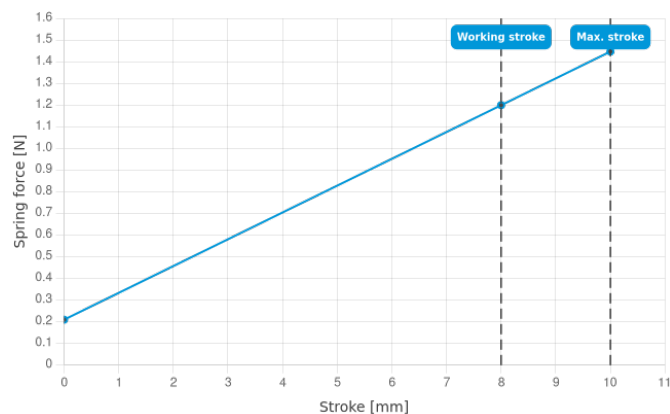

INGUN Prüfmittelbau GmbH

Max-Stromeyer-Straße 162
78467, Constance, Germany
Phone +49 7531 8105-0
Customer hotline +49 7531 8105-888
Fax +49 7531 8105-65
info@ingun.com



Prices and delivery times on request.
Technical changes reserved. 11/25_GB

Learn more about
ICT/FCT Test probes



ingun.com

ICT/FCT TEST PROBES