

Receptacle KS-100 WL

Item KS-100WL



GO TO PRODUCT

ingun[®]

Partner for Future Technology

INGUN SELECTION

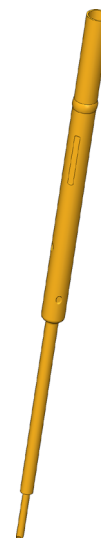

1:1

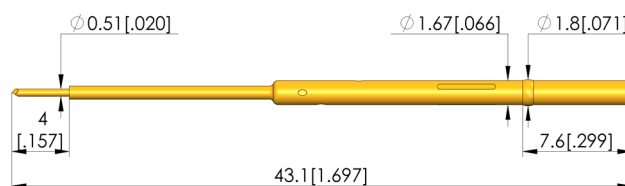

General data

Product group:	Wireless receptacles, (KS-WL)
Series:	KS-100
Sub-series:	KS-100 WL press-in version, wireless
Type of receptacle connection:	Wireless
Press ring:	Yes
Surface area:	Gold
Collar diameter:	1.85 mm [.072 in]
Collar height:	7.6 mm [.299 in]
Knurl:	No
Vacuum-tight:	yes (< 1 ccm / min)
Min. temperature:	-40 °C [-40 °F]
Max. temperature:	80 °C [176 °F]
RoHS-compliant:	Yes

Electrical data

Current load capacity / rated current:	2 A
Typical resistance (Ri):	20 mOhm

Mechanical data

Total length:	43.1 mm [1.69 in]
Outer diameter:	1.67 mm [.065 in]
Recommended working stroke:	2.5 mm [.098 in]

Mounting hole

Mounting hole in CEM1:	1.68 – 1.69 mm [.066 – .066 in]
Mounting hole in FR4:	1.69 – 1.7 mm [.066 – .066 in]
Mounting hole with press ring in CEM1:	1.7 – 1.75 mm [.066 – .068 in]
Mounting hole with press ring in FR4:	1.7 – 1.75 mm [.066 – .068 in]

Wireless receptacle data

Tip style material (wireless):	3 CuBe
Tip style plating (wireless):	A gold
Tip style (wireless):	07 90° 3-edged chisel, self-cleaning
Tip diameter (wireless):	0.51 mm [.02 in]
Maximum stroke (wireless):	4 mm [.157 in]
Spring pre-load (wireless):	0.5 N [1.79 ozf]
Spring force at working stroke:	1 N [3.59 ozf]

INGUN Prüfmittelbau GmbH

Max-Stromeyer-Straße 162
78467, Constance, Germany
Phone +49 7531 8105-0
Customer hotline +49 7531 8105-888
Fax +49 7531 8105-65
info@ingun.com



Prices and delivery times on request.
Technical changes reserved. 03/26_GB

Learn more about
Test probes

