

# Interface support

## SSA-KMFT-VA4040

Item 113551



GO TO PRODUCT

**ingun**<sup>®</sup>

Partner for Future Technology

- Interface support für REINHARDT KMFT interface
- Ideally designed for VA 4040 test fixtures
- Quick, easy installation on the back of the test fixture
- Reliable connection from test fixture to system interface

### Application

The interface frame (SSA) is used for reliable connection of the interface (SST) to the test fixture.

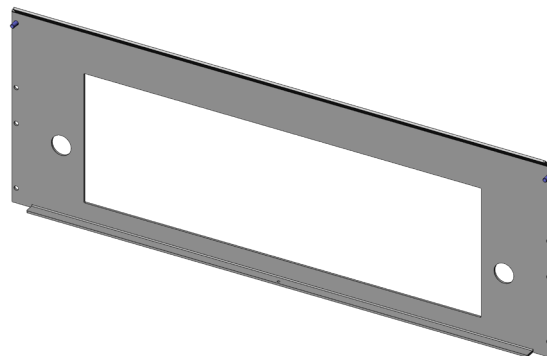

### General data

Product group:

Series:

Type:

Version:

Accessory type:

Scope of delivery:

Width:

Height:

Weight:

Min. temperature:

Max. temperature:

RoHS-compliant:

Housing

SSA-VAxxxx

KMFT (Reinhardt)

VA 4040

Additional function

Unassembled

12 mm [.472 in]

200 mm [7.87 in]

0.35 kg [.771 lbs]

10 °C [50 °F]

60 °C [140 °F]

Yes

### Compatible with

Vacuum test fixtures (VA):

Accessories:

VA 4040

SST-KMFT

### Technical data

Length:

545 mm [21.4 in]

Outer dimensionS (WxDxH): 545 x 12 x 200 mm [21.4 x .472 x 7.87 in]

### INGUN Prüfmittelbau GmbH

Max-Stromeyer-Straße 162

78467, Constance, Germany

Phone +49 7531 8105-0

Customer hotline +49 7531 8105-888

Fax +49 7531 8105-65

info@ingun.com



Prices and delivery times on request.  
Technical changes reserved. 11/25\_GB

Learn more about  
Test fixture kits

