



GO TO PRODUCT

- Component for the Opens test, for capacitive testing of semiconductor chips for open circuits, short circuits and soldering faults
- Suitable for all Keysight 307x test systems with software version 9.2 or higher
- Improved repeating accuracy, test coverage and error detection in comparison to VTEP technology

### Application

The nanoVTEP test probes are used for capacitive testing of integrated circuits in order to check the wire-bonded connections inside an integrated circuit for breakage, short circuits, and solder defects. The nanoVTEP test probes are Keysight's latest vectorless opens test solution and replace the existing VTEP test probes. In addition to significantly improved repeating accuracy, test coverage, and defect detection, the new nanoVTEP probes offer up to 40% amplification of weak signal, as the amplifier is placed close to the sensor plate. The new nanoVTEP probes only work in conjunction with the nanoVTEP MUX boards. Both nanoVTEP and VTEP probes can be combined in one test fixture.

### INGUN SELECTION



1:1

#### Note:

For professional customisation of the KEYSIGHT nanoVTEP probes, refer to the customising instructions INFO 4250.

#### Note:

nanoVTEP probes can be safely used on all Keysight 307x test systems that have software version 9.2 or newer. If the software version you are using is older than 9.2, please contact the test system manufacturer Keysight directly



### General data

Product group:	Opens tests
Series:	OTC
Type:	Keysight Vectorless Test
Version:	nanoVTEP amplifier
Accessory type:	Customising accessories
Min. temperature:	10 °C [50 °F]
Max. temperature:	60 °C [140 °F]
RoHS-compliant:	Yes

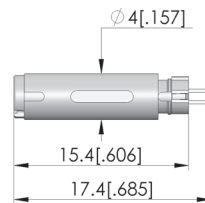

### Compatible with

Vacuum test fixtures (VA):  
Interchangeable kits (WS):

VA 2070S/L

### Technical data

Length: 17.4 mm [.685 in]  
Diameter: 4 mm [.157 in]



GO TO PRODUCT



**Accessories**

Part no.	Designation	Version
111606	OTC-KS-NV-GKS	nanoVTEP test probe
108704	OTC-KS-NV-SP-031-031	nanoVTEP sensor plate 1.2 inches
108705	OTC-KS-NV-SP-065-065	nanoVTEP sensor plate 2.5 inches
108706	OTC-KS-NV-SP-155-013	nanoVTEP sensor plate 152 mm x 12.5 mm
108710	OTE-KS-NV-064-MUX	nanoVTEP signal conditioner board
108711	OTE-KS-NV-064-MUX-REF	nanoVTEP signal conditioner board ConnectCheck

**INGUN Prüfmittelbau GmbH**

Max-Stromeyer-Straße 162  
 78467, Constance, Germany  
 Phone +49 7531 8105-0  
 Customer hotline +49 7531 8105-888  
 Fax +49 7531 8105-65  
 info@ingun.com

