

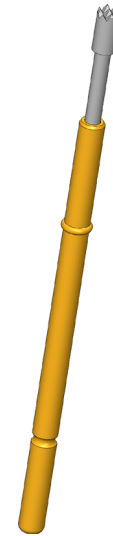

GO TO PRODUCT

- Robust test probes with distinctive collar (stop) on the barrel
- Optimum adjustment of the stroke ratios in the test fixture: The collar is available in different heights, which, in combination with the receptacles, allows a range of installation heights
- Stainless steel versions for temperatures from -100 °C up to +200 °C available

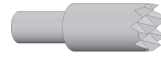

1:1

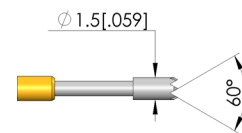
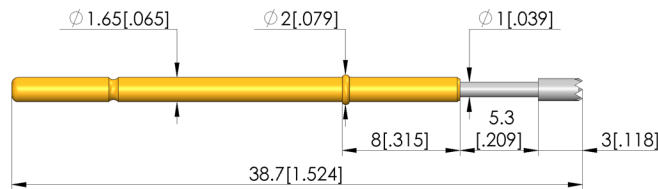
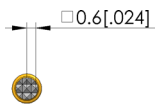

General data

Product group:
Sub-product group:
Series:
Grid:
Contacting from:
Magnetic:
Installation type:
Quick-exchange system:
Adjustable installation height:
Non-rotating:
Compatible receptacle(s):
Min. temperature:
Max. temperature:
RoHS-compliant:

ICT / FCT (in-circuit test and function test)
Metric standard
GKS-112
2.54 mm [100 mil]
Post
Yes
Plug-in
Yes
No
KS-112
-40 °C [-40 °F]
80 °C [176 °F]
Yes

Tip style data

Tip style: 06 serrated
Tip diameter: 1.5 mm [.059 in]
Tip style surface: R rhodium
Tip style material: 3 CuBe

Electrical data

Current load capacity / rated current: 8 A
Typical resistance (Ri): 20 mOhm

Mechanical data

Total length: 38.7 mm [1.52 in]
Barrel diameter: 1.66 mm [.065 in]
Maximum stroke: 5.3 mm [.208 in]
Spring pre-load: 1.49 N [5.35 ozf]
Collar height: 08
Spring force at working stroke: 5 N [17.9 ozf]
Recommended working stroke: 4 mm [.157 in]

Test Probe

GKS-112 306 150 R 5008

Item GKS-112-1358



ingun[®]

Partner for Future Technology

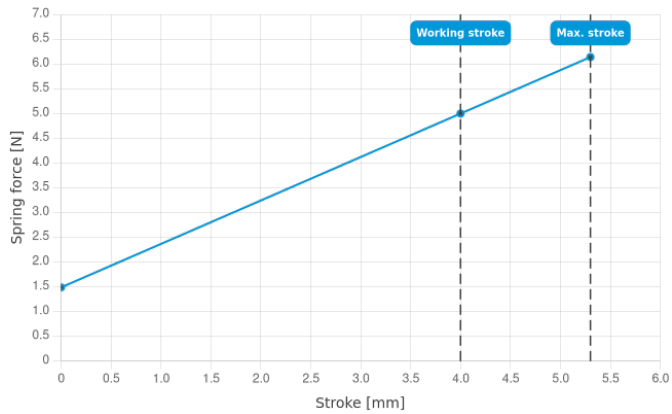

INGUN Prüfmittelbau GmbH

Max-Stromeyer-Straße 162
78467, Constance, Germany
Phone +49 7531 8105-0
Customer hotline +49 7531 8105-888
Fax +49 7531 8105-65
info@ingun.com



Prices and delivery times on request.
Technical changes reserved. 11/25_GB

Learn more about
ICT/FCT Test probes



ICT/FCT TEST PROBES

ingun.com