

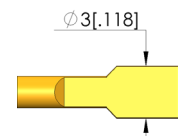

## Durchgangsprüfung

Zur Überprüfung von möglichen offenen Verbindungen, Kurzschlüssen und Fehlverdrahtungen

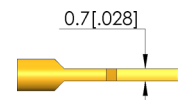
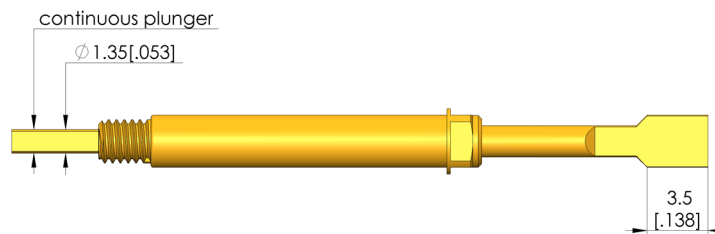
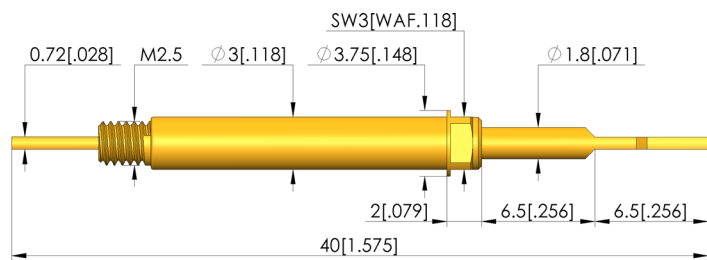
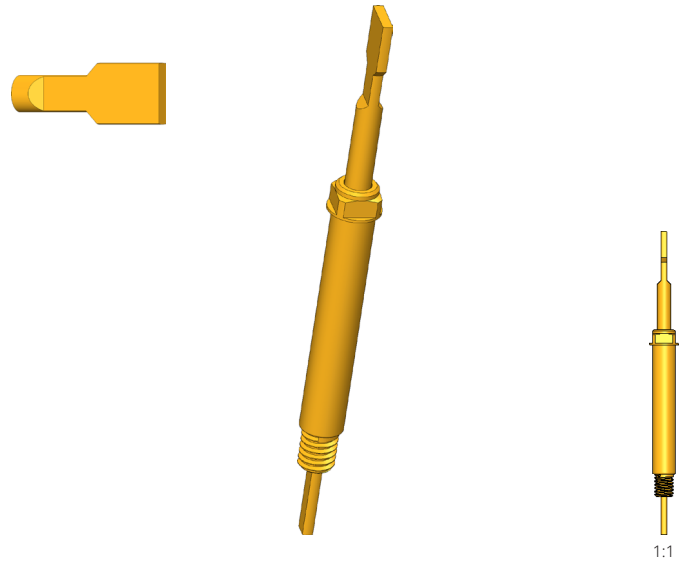

### General data

Screw-in torque max.:	20 cNm [1.77 lbf-in]
Product group:	Screw-in test probe
Sub-product group:	Non-rotating test probes
Series:	GKS-098 ML screw-in
Grid:	5.08 mm [200 mil]
Contacting from:	Female connector
Magnetic:	Yes
Installation type:	Screw-in
Quick-exchange system:	Yes
Adjustable installation height:	No
Non-rotating:	Yes
Screw-in torque:	10 – 20 cNm [885 – 1.77 lbf-in]
Compatible receptacle(s):	KS-098 M
Min. temperature:	-100 °C [-148 °F]
Max. temperature:	200 °C [392 °F]
RoHS-compliant:	Yes

### Tip style data

Tip style:	29 spade, flat with flat head
Tip diameter:	3 mm [.118 in]
Tip style surface:	A gold
Tip style material:	3 CuBe
Spade width:	0.7 mm [.027 in]
Spade length:	6.5 mm [.255 in]

### Electrical data

Current load capacity / rated current:	10 A
Typical resistance (Ri):	100 mOhm

### Mechanical data

Total length:	40 mm [1.57 in]
Barrel diameter:	3 mm [.118 in]
Maximum stroke:	5 mm [.196 in]
Spring pre-load:	0.96 N [3.45 ozf]
Collar height:	02
Spring force at working stroke:	3 N [10.7 ozf]
Recommended working stroke:	4 mm [1.57 in]

# Test Probe

## GKS-098 329 300 070 A 3002 ML

Item GKS-098-0004



GO TO PRODUCT

# ingun®

Partner for Future Technology

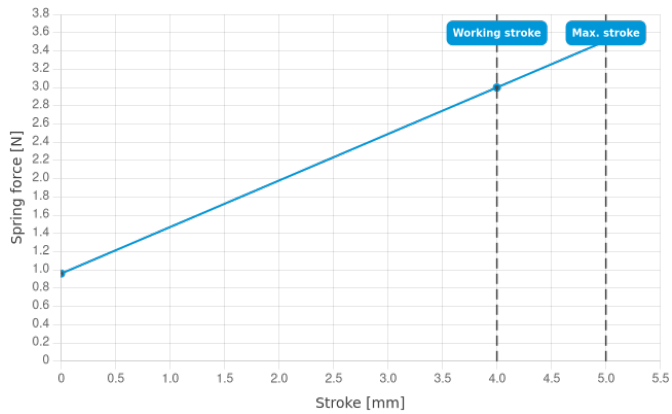

### INGUN Prüfmittelbau GmbH

Max-Stromeyer-Straße 162  
78467, Constance, Germany  
Phone +49 7531 8105-0  
Customer hotline +49 7531 8105-888  
Fax +49 7531 8105-65  
info@ingun.com



Prices and delivery times on request.  
Technical changes reserved. 05/26\_GB

Learn more about  
Screw-in test probe



SCREW-IN TEST PROBE

ingun.com