

# Receptacle

## KS-113 30 M2-R-S

Item KS-11330M2-R-S



GO TO PRODUCT

ingun®

Partner for Future Technology

## Kontaktsteckhülsen

Mit Gewinde zum Einpressen in das Trägermaterial

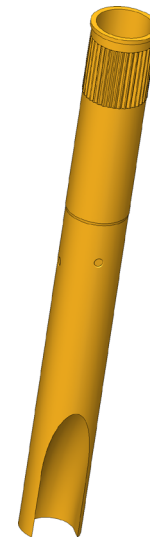

1:1

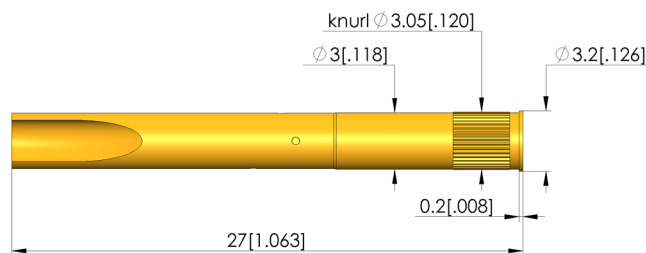

### General data

Product group:  
Series:  
Sub-series:  
Type of receptacle connection:  
Press ring:  
Surface area:  
Collar diameter:  
Collar height:  
Knurl:  
Vacuum-tight:  
RoHS-compliant:

Receptacles (KS)  
KS-113  
KS-113 M screw-in version  
Solder  
No  
Gold  
3.2 mm [.125 in]  
0.2 mm [.007 in]  
Yes  
No  
Yes

### Mechanical data

Total length: 27 mm [1.06 in]  
Outer diameter: 3 mm [.118 in]

### Mounting hole

Mounting hole in CEM1: 3 – 3.02 mm [.118 – .118 in]  
Mounting hole in FR4: 3 – 3.02 mm [.118 – .118 in]

### INGUN Prüfmittelbau GmbH

Max-Stromeyer-Straße 162  
78467, Constance, Germany  
Phone +49 7531 8105-0  
Customer hotline +49 7531 8105-888  
Fax +49 7531 8105-65  
info@ingun.com



Prices and delivery times on request.  
Technical changes reserved. 03/26\_GB

Learn more about  
Test probes

