

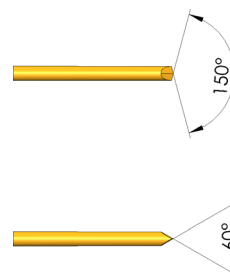

GO TO PRODUCT

- Long-stroke test probe for implementing combined ICT and FCT in a dual-stage fixture
- For optimum contact at the test points (e.g. pads, vias, and pins), various tip styles in different diameters and finishes, as well as various spring forces are available. spring forces.
- Used for setting the optimum stroke conditions in the test fixture, various installation heights can be achieved by combining test probes and receptacles

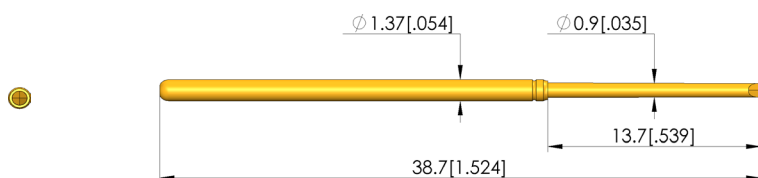
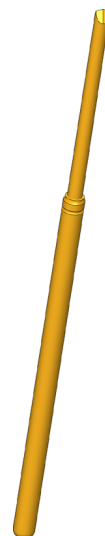

### General data

Product group:	ICT / FCT (in-circuit test and function test)
Sub-product group:	Long stroke GKS
Series:	GKS-135
Grid:	2.54 mm [100 mil]
Contacting from:	
Magnetic:	Yes
Installation type:	Plug-in
Quick-exchange system:	Yes
Adjustable installation height:	No
Non-rotating:	No
Compatible receptacle(s):	KS-100
Min. temperature:	-40 °C [-40 °F]
Max. temperature:	80 °C [176 °F]
RoHS-compliant:	Yes

### Tip style data

Tip style:	38 150° passive dagger, self-cleaning
Tip diameter:	0.9 mm [.035 in]
Tip style surface:	A gold
Tip style material:	2 steel
Step probe tip height:	2.54 mm [.1 in]

### Electrical data

Current load capacity / rated current:	8 A
Typical resistance (Ri):	30 mOhm

### Mechanical data

Total length:	38.7 mm [1.52 in]
Barrel diameter:	1.37 mm [.053 in]
Maximum stroke:	11.5 mm [.452 in]
Spring pre-load:	0.21 N [.755 ozf]
Collar height:	0
Spring force at working stroke:	2 N [7.19 ozf]
Recommended working stroke:	9.3 mm [.366 in]

# Test Probe

## GKS-135 238 090 A 2000

Item GKS-135-0251



**ingun**<sup>®</sup>

Partner for Future Technology

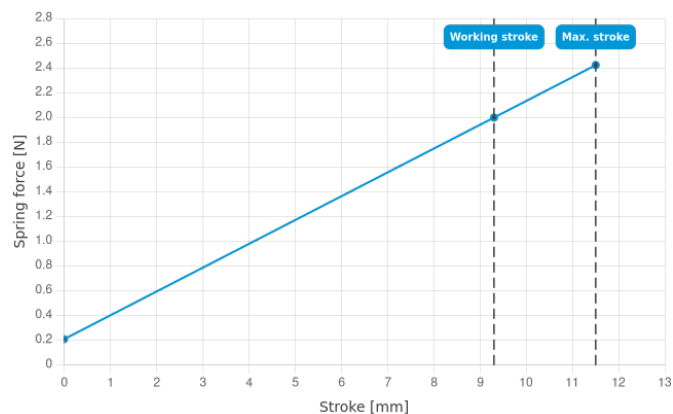

### INGUN Prüfmittelbau GmbH

Max-Stromeyer-Straße 162  
78467, Constance, Germany  
Phone +49 7531 8105-0  
Customer hotline +49 7531 8105-888  
Fax +49 7531 8105-65  
info@ingun.com



Prices and delivery times on request.  
Technical changes reserved. 11/25\_GB

Learn more about  
ICT/FCT Test probes



ICT/FCT TEST PROBES

ingun.com