

# Switching Probe (NO)

## SKS-215 302 180 A 1502

Item SKS-215-0010



GO TO PRODUCT

**ingun**<sup>®</sup>

Partner for Future Technology

- For a wide range of applications: performs components detection check, is a switch for detecting closed/open states, and a signal transmitter for process control
- The electrical connection is ensured by installation using a receptacle
- Designed as normally open (NO), i.e. The circuit is closed when actuated

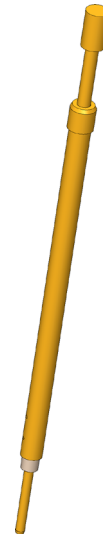
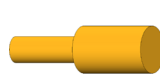

1:1

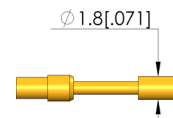
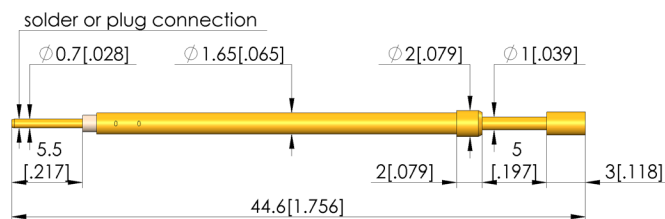

### General data

Product group:  
Sub-product group:  
Series:  
Grid:  
Contacting from:  
Magnetic:  
Installation type:  
Quick-exchange system:  
Type of test probe connection:  
Adjustable installation height:  
Non-rotating:  
Compatible connector(s):  
Compatible receptacle(s):  
Min. temperature:  
Max. temperature:  
RoHS-compliant:

SKS (pressed-in)  
SKS (pressed-in)  
SKS-215  
2.54 mm [100 mil]  
Post  
Yes  
Plug-in  
No  
Plug  
No  
No  
SE-215  
KS-215  
-40 °C [-40 °F]  
80 °C [176 °F]  
Yes

### Tip style data

Tip style:  
Tip diameter:  
Tip style surface:  
Tip style material:

02 flat  
1.8 mm [.07 in]  
A gold  
3 CuBe

### Electrical data

Current load capacity / rated current:

3 A

### Mechanical data

Total length:  
Barrel diameter:  
Maximum stroke:  
Spring pre-load:  
Collar height:  
Switch path:  
Switching point:  
Spring force at switching point:

44.6 mm [1.75 in]  
1.65 mm [.064 in]  
5 mm [.196 in]  
0.25 N [.899 ozf]  
02  
1.5 mm [.059 in]  
8.5 mm [.334 in]  
0.45 N [1.61 ozf]

### INGUN Prüfmittelbau GmbH

Max-Stromeyer-Straße 162  
78467, Constance, Germany  
Phone +49 7531 8105-0  
Customer hotline +49 7531 8105-888  
Fax +49 7531 8105-65  
info@ingun.com



Prices and delivery times on request.  
Technical changes reserved. 12/25\_GB

Learn more about  
Test probes



ingun.com