

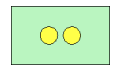

- Component for the Opens test, for capacitive testing of semiconductor chips for open circuits, short circuits and soldering faults
- Suitable for SPEA test systems

Application

The OpenPin Check sensor plate is used for capacitive testing of integrated circuits to check the wire-bonded connections inside an integrated circuit for open circuits, short circuits and soldering faults.

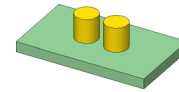

1:1

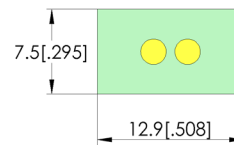
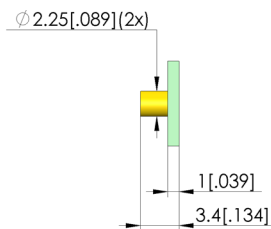

General data

| | |
|--------------------|-----------------------------|
| Product group: | Opens tests |
| Series: | OTC |
| Type: | SPEA opens test |
| Version: | Open Pin check |
| Accessory type: | Customising accessories |
| Scope of delivery: | Sensor plate Escan Captor14 |
| Width: | 7.5 mm [.295 in] |
| Height: | 3.4 mm [.133 in] |
| Weight: | 0.01 kg [.022 lbs] |
| Min. temperature: | 10 °C [50 °F] |
| Max. temperature: | 60 °C [140 °F] |
| RoHS-compliant: | Yes |

Compatible with

Interchangeable kits (WS):

WS SPEA

Technical data

| | |
|---------------------------|---|
| Length: | 12.9 mm [.507 in] |
| Outer dimensionS (WxDxH): | 7.5 x 12.9 x 3.4 mm [.295 x .507 x .133 in] |

INGUN Prüfmittelbau GmbH

Max-Stromeyer-Straße 162
78467, Constance, Germany
Phone +49 7531 8105-0
Customer hotline +49 7531 8105-888
Fax +49 7531 8105-65
info@ingun.com

