

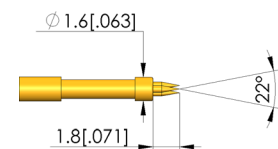

- Robust test probes with distinctive collar (stop) on the barrel
- Optimum adjustment of the stroke ratios in the test fixture:
The collar is available in different heights, which, in combination with the receptacles, allows a range of installation heights
- Version with central beading ensure low wobble for contacting small test points
- Stainless steel versions for temperatures from -100 °C up to +200 °C available

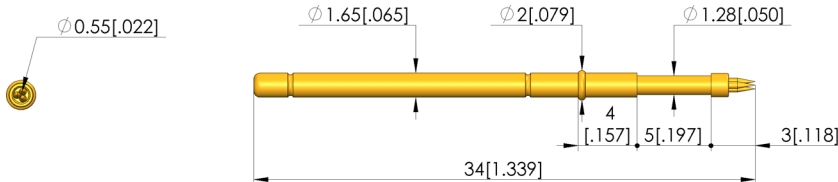
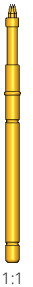
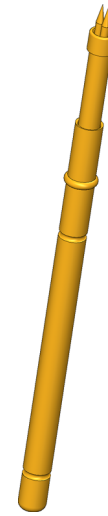

General data

Product group:
Sub-product group:
Series:
Grid:
Contacting from:
Magnetic:
Installation type:
Quick-exchange system:
Adjustable installation height:
Non-rotating:
Compatible receptacle(s):
Min. temperature:
Max. temperature:
RoHS-compliant:

ICT / FCT (in-circuit test and function test)
Metric standard
GKS-912
2.54 mm [100 mil]
Pad
Yes
Plug-in
Yes
No
No
KS-112
-40 °C [-40 °F]
80 °C [176 °F]
Yes

Tip style data

Tip style:
Tip diameter:
Tip style surface:
Tip style material:

93 pressed in steel points, 3 x 22°
1.6 mm [.062 in]
A gold
2 steel

Electrical data

Current load capacity / rated current:
Typical resistance (Ri):

5 A
20 mOhm

Mechanical data

Total length:
Barrel diameter:
Maximum stroke:
Spring pre-load:
Collar height:
Spring force at working stroke:
Recommended working stroke:

34 mm [1.33 in]
1.66 mm [.065 in]
5 mm [.196 in]
0.5 N [1.79 ozf]
04
1.5 N [5.39 ozf]
4 mm [.157 in]

Test Probe

GKS-912 293 160 A 1504

Item GKS-912-0937



ingun[®]

Partner for Future Technology

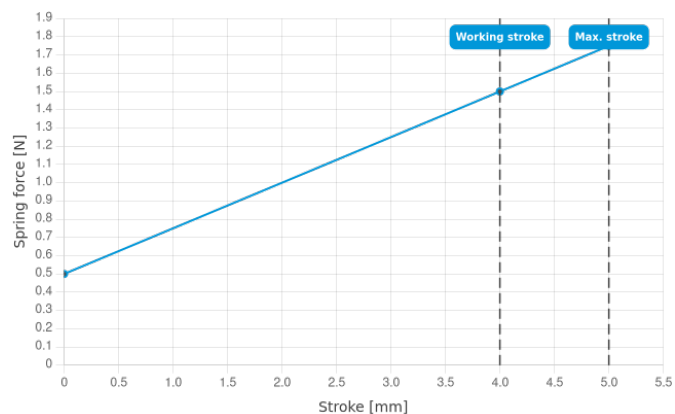

INGUN Prüfmittelbau GmbH

Max-Stromeyer-Straße 162
78467, Constance, Germany
Phone +49 7531 8105-0
Customer hotline +49 7531 8105-888
Fax +49 7531 8105-65
info@ingun.com



Prices and delivery times on request.
Technical changes reserved. 12/25_GB

Learn more about
ICT/FCT Test probes



ICT/FCT TEST PROBES

ingun.com