

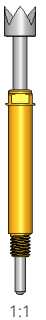

Durchgangsprüfung

Zur Überprüfung von möglichen offenen Verbindungen, Kurzschlüssen und Fehlverdrahtungen

- Screw-in test probes for applications with possible vibrations or unwanted side and axial forces (migration of the test probe out of the receptacle is reliably prevented)

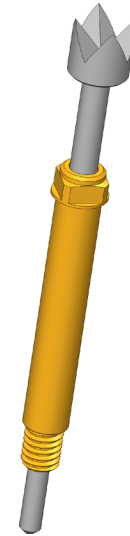

1:1

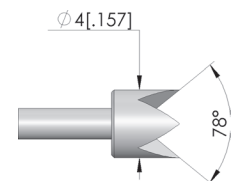
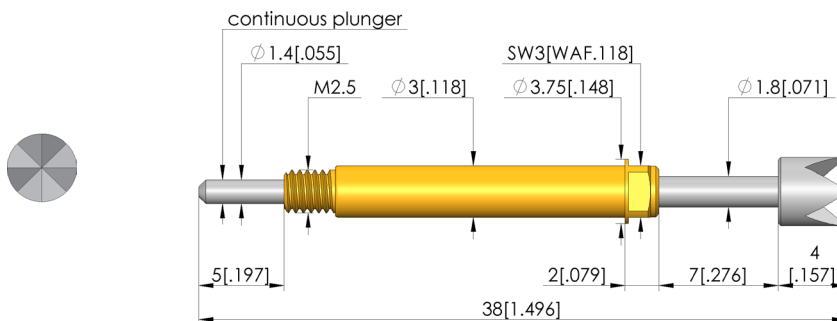

Test Probe

GKS-503 304 400 R 5002 M

Item GKS-503-0145



GO TO PRODUCT

ingun[®]

Partner for Future Technology

General data

Screw-in torque max.:	20 cNm [1.77 lbf-in]
Product group:	Screw-in test probe
Sub-product group:	Screw-in test probe
Series:	GKS-503 M screw-in
Grid:	4.5 mm [177 mil]
Contacting from:	Pad
Magnetic:	Yes
Installation type:	Screw-in
Quick-exchange system:	No
Type of test probe connection:	Plug
Adjustable installation height:	No
Non-rotating:	No
Continuous plunger:	ø1,4 x 5,0
Screw-in torque:	10 – 20 cNm [.885 – 1.77 lbf-in]
Compatible connector(s):	SE-503
Compatible receptacle(s):	KS-500 M
Min. temperature:	-100 °C [-148 °F]
Max. temperature:	200 °C [392 °F]
RoHS-compliant:	Yes

Tip style data

Tip style:	04 4-point crown
Tip diameter:	4 mm [.157 in]
Tip style surface:	R rhodium
Tip style material:	3 CuBe

Electrical data

Current load capacity / rated current:	8 A
Current rating, connection on plunger:	15 A
Typical resistance (Ri):	100 mOhm
Typical resistance (Ri), connection on plunger:	10 mOhm

Mechanical data

Total length:	38 mm [1.49 in]
Barrel diameter:	3 mm [.118 in]
Maximum stroke:	7 mm [.275 in]
Spring pre-load:	1.25 N [4.49 ozf]
Collar height:	02
Spring force at working stroke:	5 N [17.9 ozf]
Recommended working stroke:	5.6 mm [.22 in]

INGUN Prüfmittelbau GmbH

Max-Stromeyer-Straße 162
78467, Constance, Germany
Phone +49 7531 8105-0
Customer hotline +49 7531 8105-888
Fax +49 7531 8105-65
info@ingun.com



Prices and delivery times on request.
Technical changes reserved. 04/26_GB

Learn more about
Screw-in test probe



ingun.com