

Contact Terminal

KT-S-050 47 35

Item KT-S050-0001



GO TO PRODUCT

ingun®

Partner for Future Technology

- Use of larger test probes for increased contacting accuracy and longer service life
- Compatible with existing socketless systems
- Variable installation height allows for optimal consideration of different test point levels

NEW

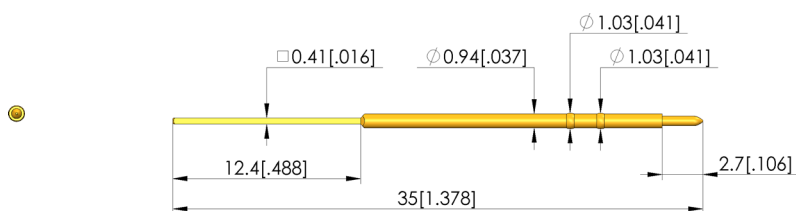
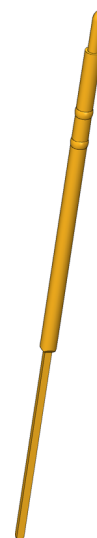

General data

Product group: Contact terminals (KT)
Series: KT-S050
Sub-series: KT-S050 standard
Grid: 1.27 mm [50 mil]
Type of contact terminal connection: Wire-wrap
Magnetic: Yes
Installation type: Press-in
Quick-exchange system: No
Surface area: A gold
Material: 3 CuBe
Knurl: No
RoHS-compliant: Yes

Contact terminals (KT)
KT-S050
KT-S050 standard
1.27 mm [50 mil]
Wire-wrap
Yes
Press-in
No
A gold
3 CuBe
No
Yes

Tip style data

Tip diameter: 0.64 mm [.025 in]

Mechanical data

Total length: 35 mm [1.37 in]
Shaft diameter: 0.94 mm [.037 in]
Latching lug: No

Mounting hole

Mounting hole in CEM1: 0.97 – 0.99 mm [.038 – .038 in]
Mounting hole in FR4: 0.97 – 0.99 mm [.038 – .038 in]

INGUN Prüfmittelbau GmbH

Max-Stromeyer-Straße 162
78467, Constance, Germany
Phone +49 7531 8105-0
Customer hotline +49 7531 8105-888
Fax +49 7531 8105-65
info@ingun.com



Prices and delivery times on request.
Technical changes reserved. 03/26_GB

Learn more about
Test probes



ingun.com