

Battery contacting probe

BCP-690 360 500 A 10002

Item BCP-690-0001



GO TO PRODUCT

ingun[®]

Partner for Future Technology

- Ideal for end-of-line validation of cells and batteries - designed specifically for applications such as OCV, AC-IR, insulation measurement and Hi-Pot measurement
- Maximum process reliability – Large stroke compensates cell tolerances and process variations, ensuring a stable contact
- Designed for continuous operation ($\geq 500k$ cycles) - Minimizes downtime and maintenance – ideal for high-volume battery cell production
- Stable, low contact resistance when contacting through oxide layers - due to aggressive and serrated tip and continuous plunger design
- Easy Installation - simple assembly because of the push-in type design
- Maximum integration flexibility - Multiple connection options (plug-in, threaded, soldering) enable seamless integration into any test setup

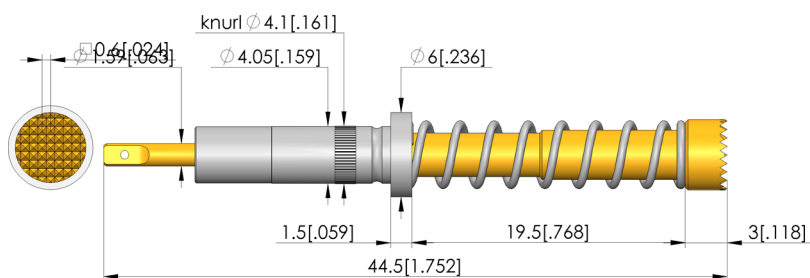
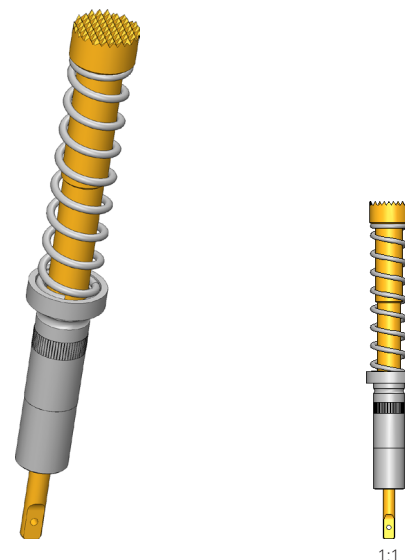

General data

| | |
|---------------------------------|-------------------------|
| Product group: | Battery Contacting |
| Sub-product group: | Standard BCP (press-in) |
| Series: | BCP-690 |
| Application rec.: | |
| Grid: | 7 mm [275 mil] |
| Magnetic: | Yes |
| Installation type: | Press-in |
| Quick-exchange system: | No |
| Type of test probe connection: | Plug |
| Adjustable installation height: | No |
| Non-rotating: | No |
| Compatible connector(s): | SE-AWG20-0002 |
| Min. temperature: | -100 °C [-148 °F] |
| Max. temperature: | 200 °C [392 °F] |
| RoHS-compliant: | Yes |

Tip style data

| | |
|---------------------|-------------------------|
| Tip style: | 60 serrated, small grid |
| Tip diameter: | 5 mm [.196 in] |
| Tip style surface: | A gold |
| Tip style material: | 3 CuBe |

Electrical data

| | |
|--|--------|
| Current load capacity / rated current: | 20 A |
| Typical resistance (Ri): | 2 mOhm |

Mechanical data

| | |
|-------------------------------------|--------------------------------|
| Total length: | 44.5 mm [1.75 in] |
| Barrel diameter: | 4.1 mm [.161 in] |
| Maximum stroke: | 10 mm [.393 in] |
| Spring pre-load: | 3.85 N [13.8 ozf] |
| Collar height: | 02 |
| Spring force at working stroke: | 10 N [35.9 ozf] |
| Recommended working stroke: | 5 mm [.196 in] |
| Mounting hole in probe plate (KTP): | 4.07 - 4.09 mm [.16 - .161 in] |

Battery contacting probe BCP-690 360 500 A 10002

Item BCP-690-0001



ingun[®]

Partner for Future Technology

Tool

| Part no. | Designation | Version |
|----------|-------------|----------------|
| SW-0016 | SW-BCP-690 | Insertion Tool |

INGUN Prüfmittelbau GmbH

Max-Stromeyer-Straße 162
78467, Constance, Germany
Phone +49 7531 8105-0
Customer hotline +49 7531 8105-888
Fax +49 7531 8105-65
info@ingun.com



Prices and delivery times on request.
Technical changes reserved. 05/26_GB

Learn more about
Test probes

