

# High-current test probe

## HSS-120 303 300 A 1510

Item HSS-120-0015



GO TO PRODUCT

**ingun**<sup>®</sup>

Partner for Future Technology

- Trusted, robust high-current probes, optimally sized for current load capacity ratio
- Low-Ohm probe with Ri typical: < 10 mOhm
- For use in function and burn-in tests
- Large selection of tip styles and spring forces for optimum contact with DUT
- Optimum adjustment of the stroke ratios in the test fixture: The test probe collar is available in different heights, which, in combination with the receptacles, allows a range of installation heights

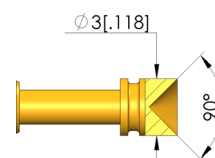
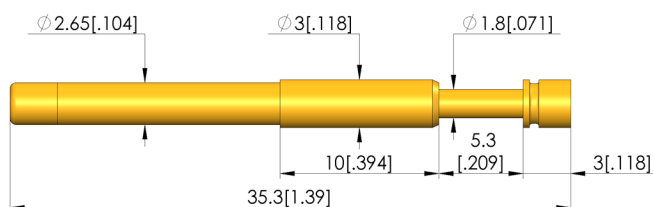
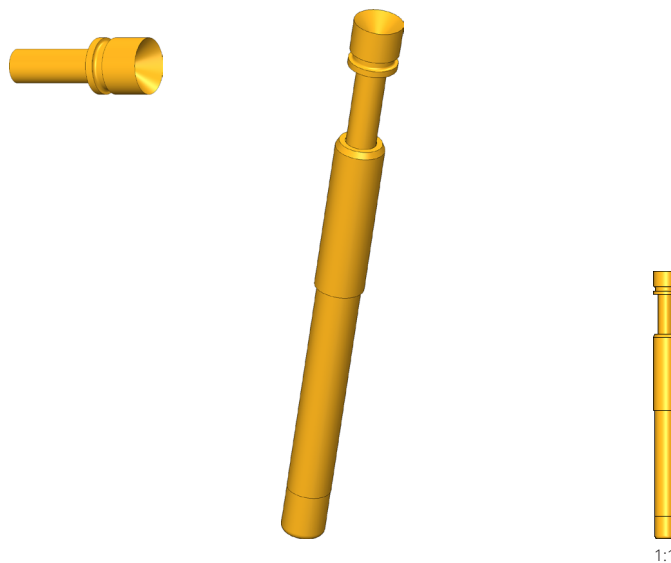

1:1

### General data

Product group:	Standard HSS (press-in)
Sub-product group:	Standard HSS (press-in)
Series:	HSS-120
Grid:	4 mm [157 mil]
Contacting from:	Post
Magnetic:	Yes
Installation type:	Plug-in
Quick-exchange system:	Yes
Adjustable installation height:	No
Non-rotating:	No
Compatible receptacle(s):	KS-113
Min. temperature:	-100 °C [-148 °F]
Max. temperature:	200 °C [392 °F]
RoHS-compliant:	Yes

### Tip style data

Tip style:	03 inverse cone
Tip diameter:	3 mm [.118 in]
Tip style surface:	A gold
Tip style material:	3 CuBe

### Electrical data

Current load capacity / rated current:	30 A
Typical resistance (Ri):	10 mOhm

### Mechanical data

Total length:	35.3 mm [1.38 in]
Barrel diameter:	2.65 mm [.104 in]
Maximum stroke:	5.3 mm [.208 in]
Spring pre-load:	0.39 N [1.4 ozf]
Collar height:	10
Spring force at working stroke:	1.5 N [5.39 ozf]
Recommended working stroke:	4 mm [.157 in]

HIGH-CURRENT TEST PROBES

# High-current test probe HSS-120 303 300 A 1510

Item HSS-120-0015



**ingun**<sup>®</sup>

Partner for Future Technology

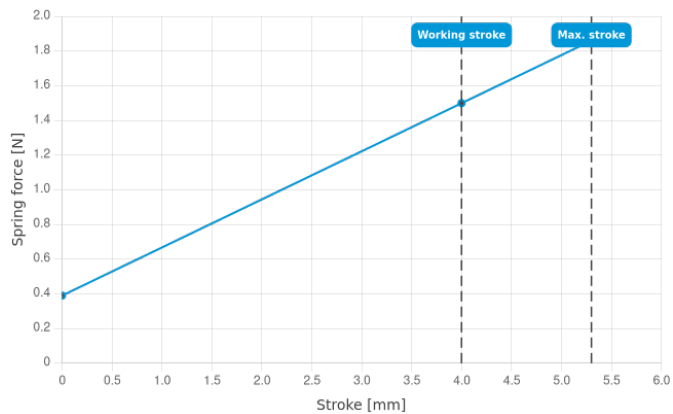

## INGUN Prüfmittelbau GmbH

Max-Stromeyer-Straße 162  
78467, Constance, Germany  
Phone +49 7531 8105-0  
Customer hotline +49 7531 8105-888  
Fax +49 7531 8105-65  
info@ingun.com



Prices and delivery times on request.  
Technical changes reserved. 11/25\_GB

Learn more about  
High-current test probes



ingun.com

HIGH-CURRENT TEST PROBES