

# Receptacle KS-913 35 M

Item KS-91335M



GO TO PRODUCT

ingun®

Partner for Future Technology

## Kontaktsteckhülsen

Mit Gewinde zum Einpressen in das Trägermaterial

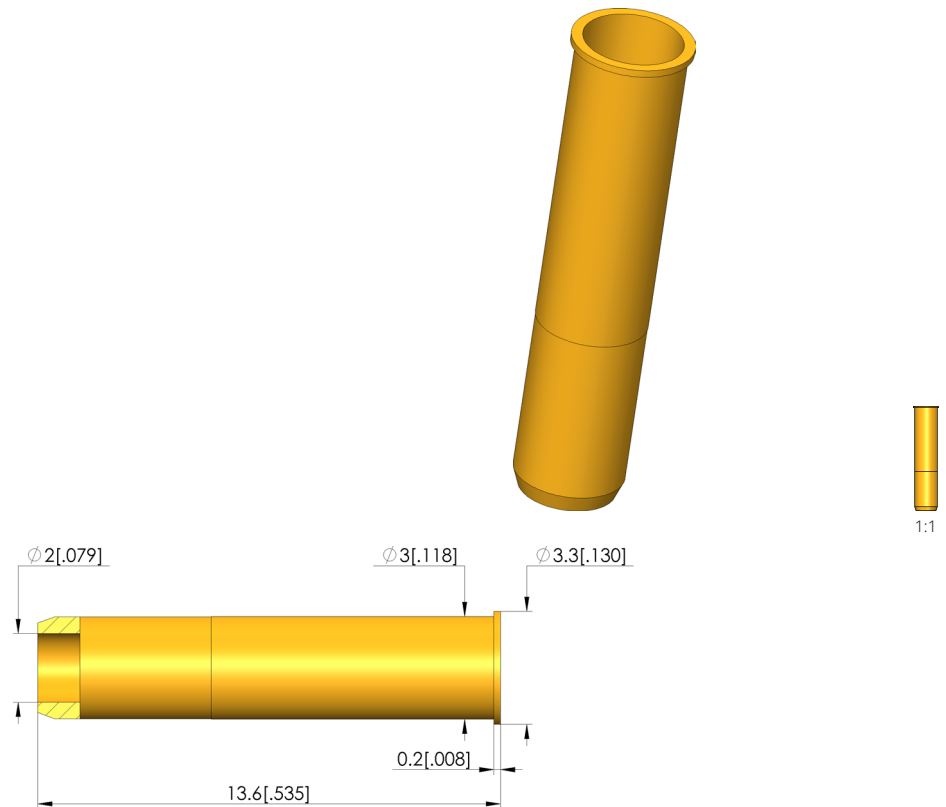

### General data

Product group: Receptacles (KS)  
Series: KS-913  
Sub-series: KS-913 M screw-in version  
Type of receptacle connection: Plug / open  
Press ring: No  
Surface area: Gold  
Collar diameter: 3.3 mm [.129 in]  
Collar height: 0.2 mm [.007 in]  
Knurl: No  
Vacuum-tight: No  
RoHS-compliant: Yes

### Mechanical data

Total length: 13.6 mm [.535 in]  
Outer diameter: 3 mm [.118 in]

### Mounting hole

Mounting hole in CEM1: 2.98 – 2.99 mm [.117 – .117 in]  
Mounting hole in FR4: 2.98 – 2.99 mm [.117 – .117 in]

### INGUN Prüfmittelbau GmbH

Max-Stromeyer-Straße 162  
78467, Constance, Germany  
Phone +49 7531 8105-0  
Customer hotline +49 7531 8105-888  
Fax +49 7531 8105-65  
info@ingun.com



Prices and delivery times on request.  
Technical changes reserved. 03/26\_GB

Learn more about  
Test probes

