

# Receptacle KS-100 35 G

Item KS-10035G



GO TO PRODUCT

**ingun**<sup>®</sup>

Partner for Future Technology

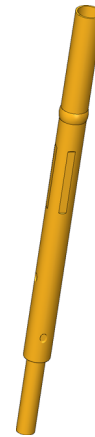

1:1

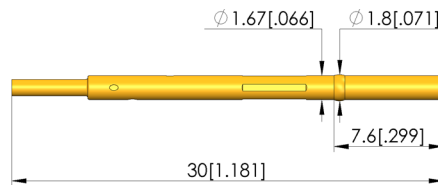

## General data

Product group:  
Series:  
Sub-series:  
Type of receptacle connection:  
Press ring:  
Surface area:  
Collar diameter:  
Collar height:  
Knurl:  
Vacuum-tight:  
RoHS-compliant:

Receptacles (KS)  
KS-100  
KS-100 35 G press-in version  
Plug / open  
Yes  
Gold  
1.85 mm [.072 in]  
7.6 mm [.299 in]  
No  
No  
Yes

## Mechanical data

Total length: 30 mm [1.18 in]  
Outer diameter: 1.67 mm [.065 in]

## Mounting hole

Mounting hole in CEM1: 1.68 – 1.69 mm [.066 – .066 in]  
Mounting hole in FR4: 1.69 – 1.7 mm [.066 – .066 in]

## INGUN Prüfmittelbau GmbH

Max-Stromeyer-Straße 162  
78467, Constance, Germany  
Phone +49 7531 8105-0  
Customer hotline +49 7531 8105-888  
Fax +49 7531 8105-65  
info@ingun.com



Prices and delivery times on request.  
Technical changes reserved. 04/26\_GB

Learn more about  
Test probes

