

Push rod

NHS-GF-23,2-5,0-KU-ST-ESD

Item 49097

[GO TO PRODUCT](#)

ingun[®]

Partner for Future Technology

- Trusted push rod for reliable, spring-loaded fixing of the PCB in the probe field against the force of the test probes
- Robust, spring-loaded design
- Quick, easy installation
- Incl. KS-113 23 receptacle
- Suitable as tooling pin for PCBs which are centred from above

Application

Push rods (NHS) are used in customisations to securely hold electronic circuit boards in place against the force of the test probes during contacting in the test fixture. Push rods are mounted in the pressure frame plate.



General data

Product group:	Push rods (NHS)
Series:	NHS-GF
Type:	Spring-loaded
Version:	Not ESD compliant
Accessory type:	Customising accessories
Outer dimensions (TxL):	5 x 58 mm [.196 x 2.28 in]
Colour:	Gold
RoHS-compliant:	Yes

Mechanical data

Total length:	58 mm [2.28 in]
---------------	-----------------

Technical data

Tip diameter:	5 mm [.196 in]
Pushrod shaft diameter:	3 mm [.118 in]
Tip material:	Plastic
Shaft material:	CuBe
Installation:	Plugged
Thread:	Ø 2,99 mm
Pushrod working stroke :	11.2 mm [.44 in]
Tip length:	6 mm [.236 in]
Pushrod installation height:	18 mm [.708 in]
Spring force:	5 N [17.9 ozf]

Push rod

NHS-GF-23,2-5,0-KU-ST-ESD

Item 49097

[GO TO PRODUCT](#)

ingun[®]

Partner for Future Technology

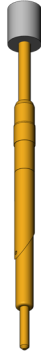

INGUN Prüfmittelbau GmbH

Max-Stromeyer-Straße 162
78467, Constance, Germany
Phone +49 7531 8105-0
Customer hotline +49 7531 8105-888
Fax +49 7531 8105-65
info@ingun.com



Prices and delivery times on request.
Technical changes reserved. 12/25_GB