

Push rod

NHS-GF-20,0-5,0-KU-ST-ESD

Item 49893



GO TO PRODUCT

ingun[®]

Partner for Future Technology

- Trusted push rod for reliable, spring-loaded fixing of the PCB in the probe field against the force of the test probes
- Robust, spring-loaded design
- Quick, easy installation
- Incl. KS-113 23 receptacle

Application

Push rods (NHS) are used in customisations to securely hold electronic circuit boards in place against the force of the test probes during contacting in the test fixture. Push rods are mounted in the pressure frame plate.

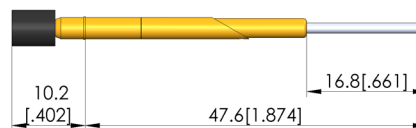
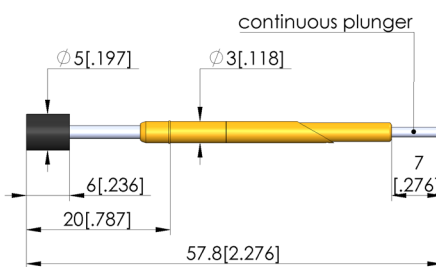
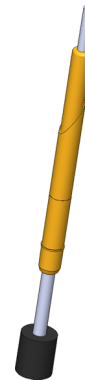

General data

Product group:

Series:

Type:

Version:

Accessory type:

Outer dimensions (TxL):

Colour:

RoHS-compliant:

Push rods (NHS)

NHS-GF

Spring-loaded

ESD

Customising accessories

5 x 57.8 mm [.196 x 2.27 in]

Gold

Yes

Compatible with

Exchangeable kits version:

Manual test fixtures (MA):

MA exchangeable kits (ATS MA):

ESD

MA 20xx

ATS MAxx

Technical data

Tip diameter:

5 mm [.196 in]

Pushrod shaft diameter:

3 mm [.118 in]

Tip material:

Plastic

Shaft material:

CuBe

Installation:

Plugged

Thread:

ø 2,99 mm

Pushrod working stroke :

9.7 mm [.381 in]

Tip length:

6 mm [.236 in]

Pushrod installation height:

18 mm [.708 in]

Spring force:

3 N [10.7 ozf]

INGUN Prüfmittelbau GmbH

Max-Stromeyer-Straße 162

78467, Constance, Germany

Phone +49 7531 8105-0

Customer hotline +49 7531 8105-888

Fax +49 7531 8105-65

info@ingun.com



Prices and delivery times on request.
Technical changes reserved. 11/25_GB