

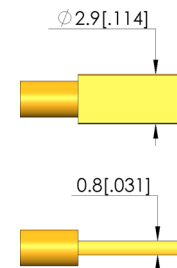

Durchgangsprüfung

Zur Überprüfung von möglichen offenen Verbindungen, Kurzschlüssen und Fehlverdrahtungen

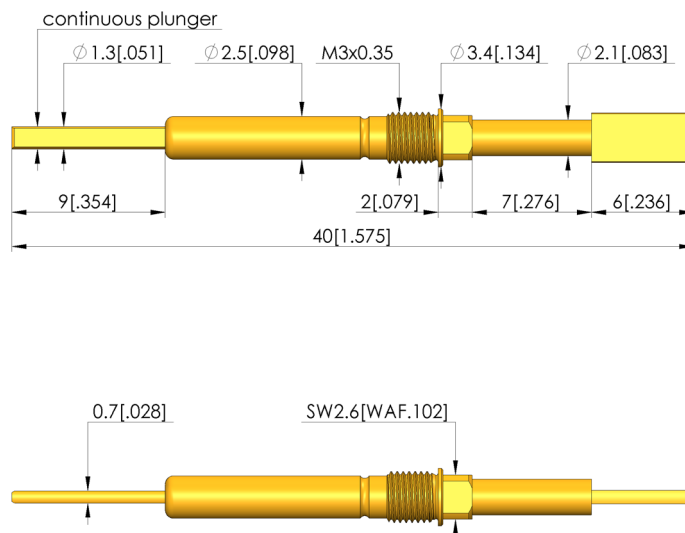
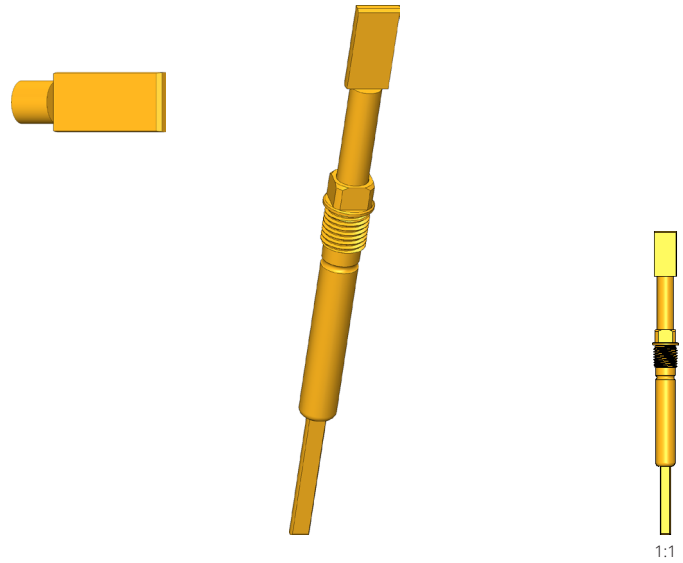

General data

Screw-in torque max.:	20 cNm [1.77 lbf-in]
Product group:	Screw-in test probe
Sub-product group:	Non-rotating test probes
Series:	GKS-747 M screw-in
Grid:	4.5 mm [177 mil]
Contacting from:	Female connector
Magnetic:	Yes
Installation type:	Screw-in
Quick-exchange system:	Yes
Adjustable installation height:	No
Non-rotating:	Yes
Continuous plunger:	$\varnothing 1,3 \times 0,7 \times 9,0$
Screw-in torque:	10 – 20 cNm [.885 – 1.77 lbf-in]
Compatible receptacle(s):	KS-747 M
Min. temperature:	-40 °C [-40 °F]
Max. temperature:	80 °C [176 °F]
RoHS-compliant:	Yes

Tip style data

Tip style:	29 spade, flat with flat head
Tip diameter:	2.9 mm [.114 in]
Tip style surface:	A gold
Tip style material:	3 CuBe
Spade width:	0.8 mm [.031 in]
Spade length:	6 mm [.236 in]

Electrical data

Current load capacity / rated current:	8 A
Typical resistance (RI):	30 mOhm

Mechanical data

Total length:	40 mm [1.57 in]
Barrel diameter:	2.5 mm [.098 in]
Maximum stroke:	5 mm [.196 in]
Spring pre-load:	0.72 N [2.58 ozf]
Collar height:	02
Spring force at working stroke:	1.5 N [5.39 ozf]
Recommended working stroke:	4 mm [.157 in]

Test Probe

GKS-747 329 298 A 1502 M

Item GKS-747-0001



GO TO PRODUCT

ingun®

Partner for Future Technology

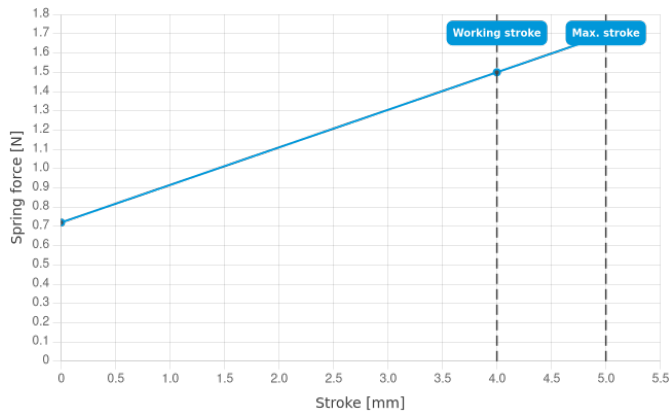

INGUN Prüfmittelbau GmbH

Max-Stromeyer-Straße 162
78467, Constance, Germany
Phone +49 7531 8105-0
Customer hotline +49 7531 8105-888
Fax +49 7531 8105-65
info@ingun.com



Prices and delivery times on request.
Technical changes reserved. 01/26_GB

Learn more about
Screw-in test probe



SCREW-IN TEST PROBE

ingun.com