

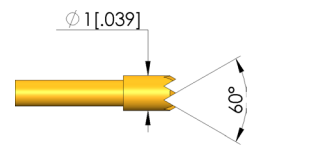

- Robust, compact design for harsh ICT/FCT applications with limited space
- For optimum contact at the test points (e.g. pads, vias, and pins), various tip styles in different diameters and finishes, as well as various spring forces are available. spring forces.

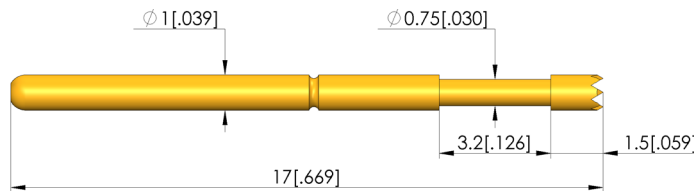
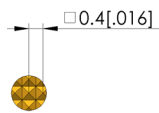
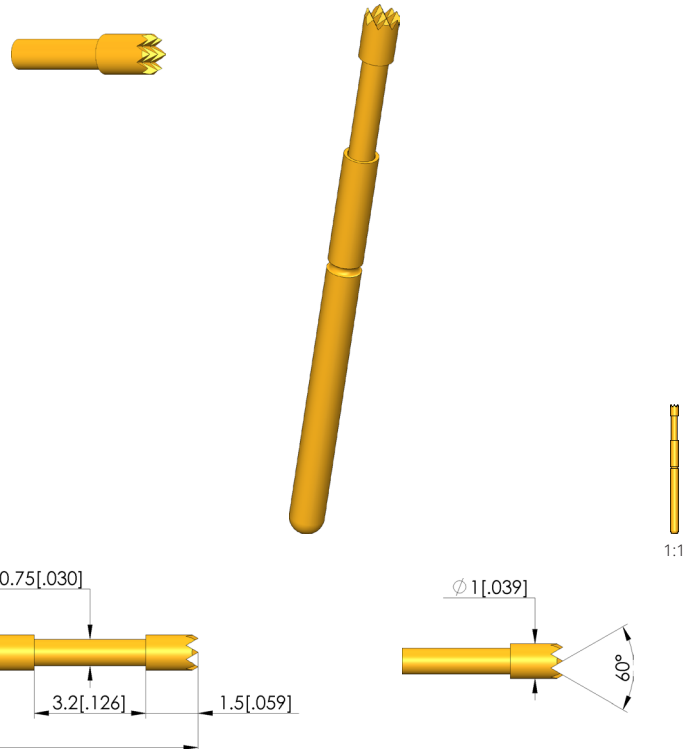

### General data

Product group:  
Sub-product group:  
Series:  
Grid:  
Contacting from:  
Magnetic:  
Installation type:  
Quick-exchange system:  
Adjustable installation height:  
Non-rotating:  
Compatible receptacle(s):  
Min. temperature:  
Max. temperature:  
RoHS-compliant:

ICT / FCT (in-circuit test and function test)  
Short/robust GKS  
GKS-001  
1.91 mm [75.1 mil]  
Post  
Yes  
Plug-in  
Yes  
No  
No  
KS-001  
-40 °C [-40 °F]  
80 °C [176 °F]  
Yes

### Tip style data

Tip style:  
Tip diameter:  
Tip style surface:  
Tip style material:

06 serrated  
1 mm [.039 in]  
A gold  
3 CuBe

### Electrical data

Current load capacity / rated current:  
Typical resistance (Ri):

4 A  
20 mOhm

### Mechanical data

Total length:  
Barrel diameter:  
Maximum stroke:  
Spring pre-load:  
Collar height:  
Spring force at working stroke:  
Recommended working stroke:

17 mm [.669 in]  
1 mm [.039 in]  
3 mm [.118 in]  
0.47 N [1.69 ozf]  
00  
1.5 N [5.39 ozf]  
2.4 mm [.094 in]

# Test Probe

## GKS-001 306 100 A 1500

Item GKS-001-0014



**ingun**<sup>®</sup>

Partner for Future Technology

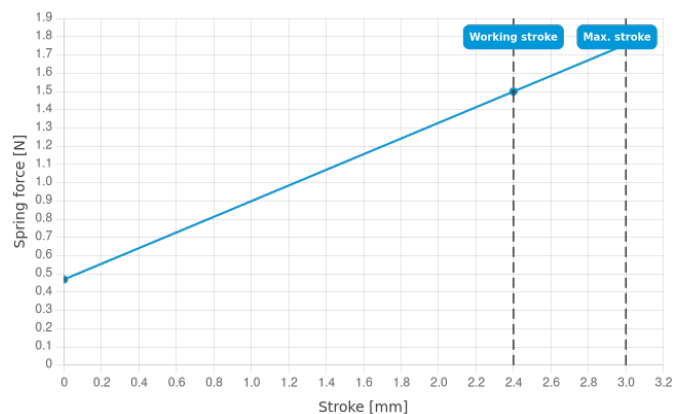

### INGUN Prüfmittelbau GmbH

Max-Stromeyer-Straße 162  
78467, Constance, Germany  
Phone +49 7531 8105-0  
Customer hotline +49 7531 8105-888  
Fax +49 7531 8105-65  
info@ingun.com



Prices and delivery times on request.  
Technical changes reserved. 11/25\_GB

Learn more about  
ICT/FCT Test probes



ingun.com