

Switching Probe (NO)

SKS-429 005 500 A 8008

Item SKS-429-0002



GO TO PRODUCT

ingun[®]

Partner for Future Technology

- For a wide range of applications: performs components detection check, is a switch for detecting closed/open states, and a signal transmitter for process control
- The electrical connection is ensured by installation using a receptacle
- Designed as normally open (NO), i.e. The circuit is closed when actuated

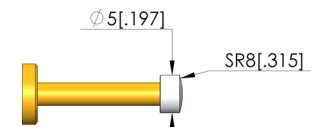
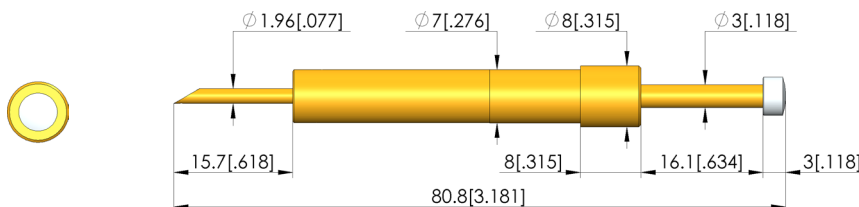
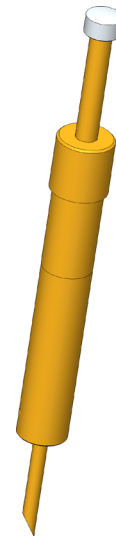
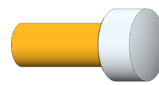

General data

Product group:
Sub-product group:
Series:
Grid:
Contacting from:
Magnetic:
Installation type:
Quick-exchange system:
Adjustable installation height:
Non-rotating:
Compatible receptacle(s):
Min. temperature:
Max. temperature:
RoHS-compliant:

SKS (pressed-in)
SKS (pressed-in)
SKS-429
10 mm [393 mil]
Presence check
Yes
Plug-in
No
No
No
KS-429
-40 °C [-40 °F]
80 °C [176 °F]
Yes

Tip style data

Tip style:
Tip diameter:
Tip style surface:
Tip style material:

005 round, contact surface insulated
5 mm [.196 in]
A gold
0 plastic

Electrical data

Current load capacity / rated current:

5 A

Mechanical data

Total length:
Barrel diameter:
Maximum stroke:
Spring pre-load:
Collar height:
Switch path:
Switching point:
Spring force at switching point:

80.8 mm [3.18 in]
7 mm [.275 in]
16 mm [.629 in]
2.23 N [8.02 ozf]
08
2 mm [.078 in]
25.1 mm [.988 in]
2.9 N [10.4 ozf]

INGUN Prüfmittelbau GmbH

Max-Stromeyer-Straße 162
78467, Constance, Germany
Phone +49 7531 8105-0
Customer hotline +49 7531 8105-888
Fax +49 7531 8105-65
info@ingun.com



Prices and delivery times on request.
Technical changes reserved. 12/25_GB

Learn more about
Test probes



ingun.com