

# Screwing unit SBE-M-15-S4

Item 40850



GO TO PRODUCT

**ingun**<sup>®</sup>

Partner for Future Technology

- For setting rotatable adjustable potentiometers during the test
- Space-saving, quick, easy installation
- Manual actuation

## Application

With screwing units (SBE), space-saving alignment of adjustable screw-in devices can be performed during testing. Operation is manual. Screwing units are typically mounted in the pressure frame plate.

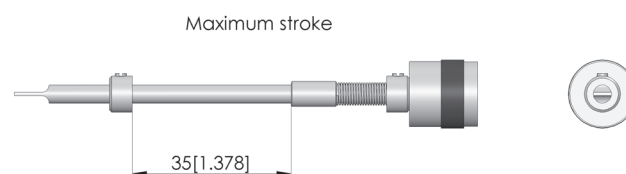
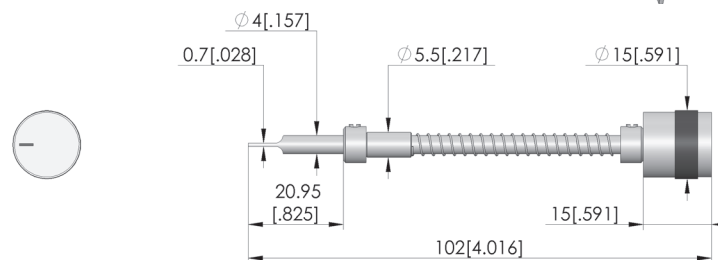
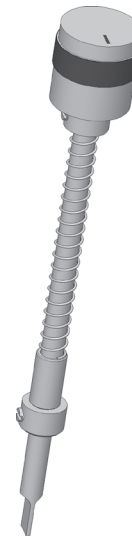

## General data

Product group:

Series:

Type:

Version:

Accessory type:

Scope of delivery:

Min. temperature:

Max. temperature:

RoHS-compliant:

Screwing units

SBE

Manual, not vacuum-tight

Customising accessories

Incl. slotted bit

10 °C [50 °F]

60 °C [140 °F]

Yes

## Compatible with

Manual test fixtures (MA):

MA exchangeable kits (ATS MA):

PA exchangeable kits (ATS PA):

For dual-stage contacting:

MA 2012

ATS MAxx

ATS PAZxxx

Yes

## Technical data

Stroke:

35 mm [1.37 in]

Tip diameter:

15 mm [.59 in]

Installation grid:

15 mm [.59 in]

Blade dimensions (WxD):

4 x 0.7 mm [.157 x .027 in]

Length:

102 mm [4.01 in]

Diameter:

15 mm [.59 in]

## INGUN Prüfmittelbau GmbH

Max-Stromeyer-Straße 162

78467, Constance, Germany

Phone +49 7531 8105-0

Customer hotline +49 7531 8105-888

Fax +49 7531 8105-65

info@ingun.com



Prices and delivery times on request.  
Technical changes reserved. 11/25\_GB