

# Reinforcement set FB-VSL-KIT-KTE-ATSMA15

Item 115008



**ingun**<sup>®</sup>

Partner for Future Technology

- To be installed under the probe plate (KTP)
- Recommended for customisations with more than 300 test probes or a force greater than 500 N
- The scope of delivery includes one strip with fixing material in each case

## Application

For reinforcing the probe plate (KTP) to prevent deflection due to high forces resulting from customisation.

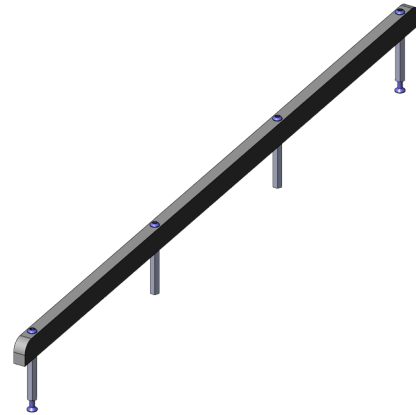

## General data

Product group:	Functional units
Series:	FB-ATSMAxx
Type:	Reinforcement bar for probe plate (KTP)
Version:	Set including installation accessories
Accessory type:	Additional function
Scope of delivery:	1 x reinforcement bar
Material:	1.0037, galvanised
Width:	10 mm [.393 in]
Height:	60 mm [2.36 in]
Weight:	1 kg [2.2 lbs]
Min. temperature:	10 °C [50 °F]
Max. temperature:	60 °C [140 °F]
RoHS-compliant:	Yes

## Compatible with

Exchangeable kits version:	No RF
MA exchangeable kits (ATS MA):	ATS MA15

## Technical data

Installation:	Thread M4
Length:	610 mm [24 in]
Outer dimensionS (WxDxH):	10 x 610 x 60 mm [.393 x 24 x 2.36 in]

# Reinforcement set **FB-VSL-KIT-KTE-ATSMA15**

Item 115008



**ingun**<sup>®</sup>

Partner for Future Technology

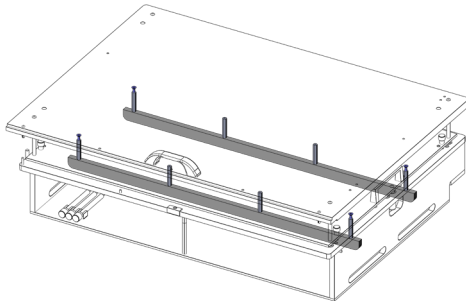

## **INGUN** Prüfmittelbau GmbH

Max-Stromeyer-Straße 162  
78467, Constance, Germany  
Phone +49 7531 8105-0  
Customer hotline +49 7531 8105-888  
Fax +49 7531 8105-65  
info@ingun.com



Prices and delivery times on request.  
Technical changes reserved. 11/25\_GB

Learn more about  
MA functional units



FUNCTIONAL UNIT

ingun.com