

Locking interface

FB-VER-F-M-GR2270/71

Item 116237



ingun[®]
Partner for Future Technology

- Dock onto Pylon receiver without lifting the test fixture via the locking latch
- Reliable locking of the closure mechanism
- Manual operation of the locking slide

Application

The functional unit is used to dock test fixtures with a Pylon interface to the Pylon receiver without having to lift the test fixture via the receiver's locking latch. The locking mechanism is opened and closed manually by simply actuating the locking slide.



General data

Product group:	Locking units
Series:	FB-RC
Type:	
Version:	GR2270/71 (manual)
Accessory type:	Additional function
Scope of delivery:	2 x locking unit, pre-installed
Material:	1.0037, galvanised
Width:	29 mm [1.14 in]
Height:	60 mm [2.36 in]
Weight:	0.45 kg [.992 lbs]
Min. temperature:	10 °C [50 °F]
Max. temperature:	60 °C [140 °F]
RoHS-compliant:	Yes

Compatible with

Accessories:	SST-GR2270/71
--------------	---------------

Technical data

Stroke:	16 mm [.629 in]
Installation:	Bore D = 3.2 mm
Length:	110 mm [4.33 in]
Outer dimensionS (WxDxH):	110 x 29 x 60 mm [4.33 x 1.14 x 2.36 in]

Locking interface FB-VER-F-M-GR2270/71

Item 116237



ingun[®]

Partner for Future Technology

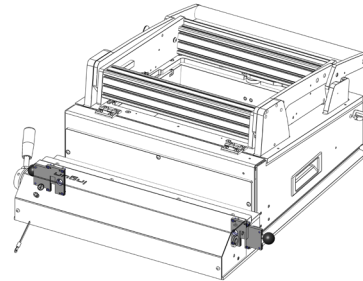
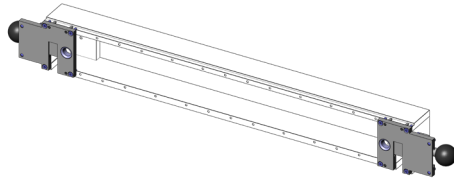

Accessories

Part no.	Designation	Version
109715	SST-GR2270/71	GR2270/71 interface

INGUN Prüfmittelbau GmbH

Max-Stromeyer-Straße 162
78467, Constance, Germany
Phone +49 7531 8105-0
Customer hotline +49 7531 8105-888
Fax +49 7531 8105-65
info@ingun.com



Prices and delivery times on request.
Technical changes reserved. 11/25_GB

Learn more about
Test fixture kits

